

Mandalay²⁰⁰⁸



 **Mandalay**
LUXURY DIVISION

EXCEEDING EXPECTATIONS...
DEFINING NEW ONES



VINTAGE MAHOGANY interior decor / NATURAL CHERRY cabinetry

MANDALAY is a Class A diesel motorhome like no other. It offers world-class luxury, extraordinary elegance and exceptional comfort. With a selection of innovative slide-out floorplans, distinctive full-body paint packages and upscale amenities both inside and out—you can tailor your new Mandalay to meet your needs, taste and lifestyle. The living area in Model 43A (pictured above), is shown with an

optional 40" LCD television in the front overhead, dual UltraLeather™ magic bed sofas, tile throughout the living room, roll-out countertop extension with storage and free-standing dinette with buffet. Model 40H (top right), features a Euro chair with ottoman, 32" LCD television in the living room entertainment center and free-standing dinette with buffet.



WILLOW LEAF interior decor / NATURAL CHERRY cabinetry

The spacious Mandalay kitchen is fully equipped with name brand appliances, including a 12-cubic foot refrigerator with ice maker and 30" Stainless Steel convection microwave oven. It also has abundant countertop and storage space to meet your food planning and preparation needs.



BLACK CORAL interior decor / NATURAL CHERRY cabinetry



VINTAGE MAHGANY interior decor / NATURAL CHERRY cabinetry



MIRAGE interior decor / CHERRY cabinetry



MIRAGE interior decor / CHERRY cabinetry

JUST RELAX AND UNWIND in your cozy bedroom after a full day of activities. It features a king-size bed with bedspread and pillows. The Select Comfort™ air mattress with dual controls allows you to adjust the bed to your most comfortable firmness. Black-out shades keep the room dark when you want to sleep, and enhance your privacy.

Model 43A (above left), has plenty of drawer, cabinet and wardrobe storage for your personal belongings. This bath-and-a-half model features a rear full master bath (above right) that includes a shower, Mystera® solid surface lavatory countertop with integrated sink and china bowl toilet.

Interior Decor

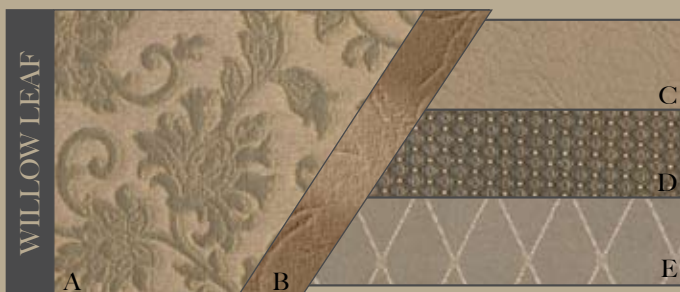
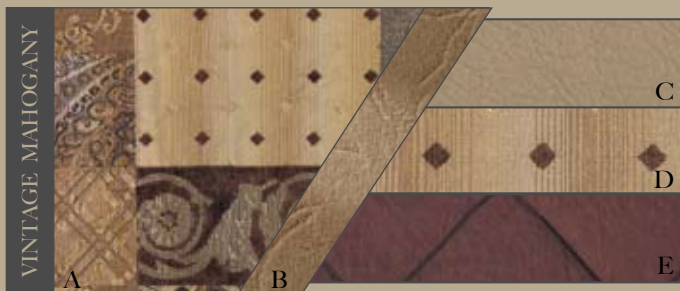
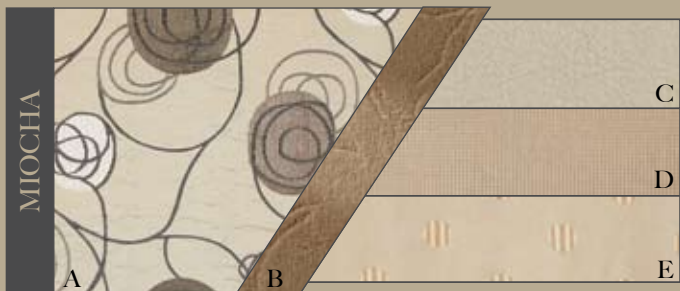
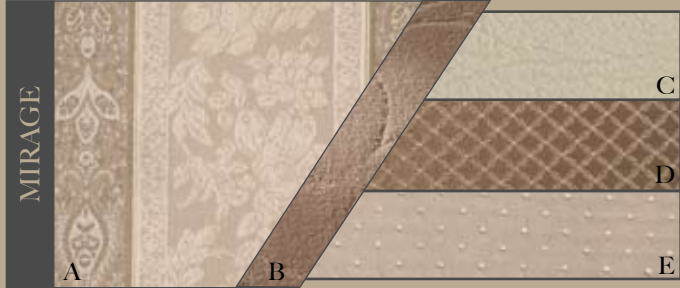
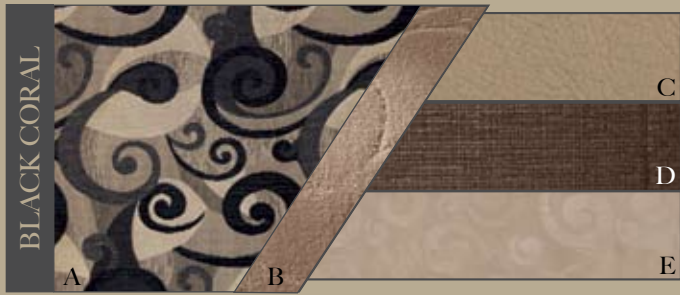

A: Main Fabric B: Carpet C: UltraLeather™ furniture
D: Window Treatments E: Bedspread



STANDARD
GOLDEN MAPLE



OPTIONAL
NATURAL CHERRY



OPTIONAL
CHERRY



The Oasis™ hydronic furnace and water heating system (right) is available as an option on Models 43A, 43B and 43C. It provides zone heating with “humid heat” throughout the motorhome for added comfort. This extra efficient system is powered by diesel fuel and electricity, so it won’t drain your LP system. It also provides continuous hot water to meet all of your daily hot water needs.

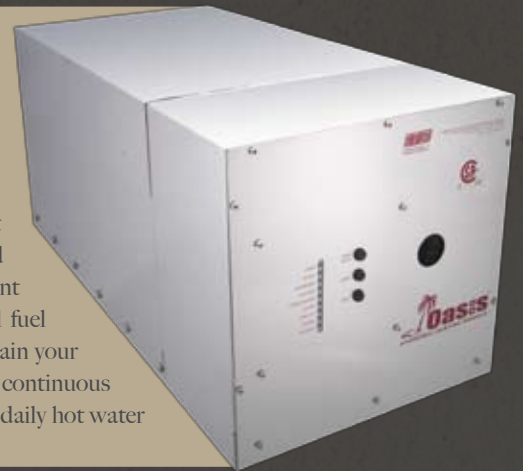

ALL MANDALAY MOTORHOMES are built on the rugged Freightliner XC raised rail chassis with a “2007 emission” 425-HP Cummins ISL engine. The cockpit (above top), features an 18” leather wrapped Smart steering wheel with cruise and wiper controls, adjustable pedals, color rear and side vision cameras, UltraLeather™ six-way power driver seat and MCD™ power sun visor and manual privacy shade system.

The sidewall mounted exterior entertainment center with 32” television (above center), is available as an option on Models 43A, 43B and 43C. An exterior entertainment center with a 26” television in the basement is available as an option on Models 40G and 40H.

Exterior Options



Calypso Bay



French Silk



Moroccan Suede



Obsidian



Santa Fe Sun



Venetian Cream

Floorplans

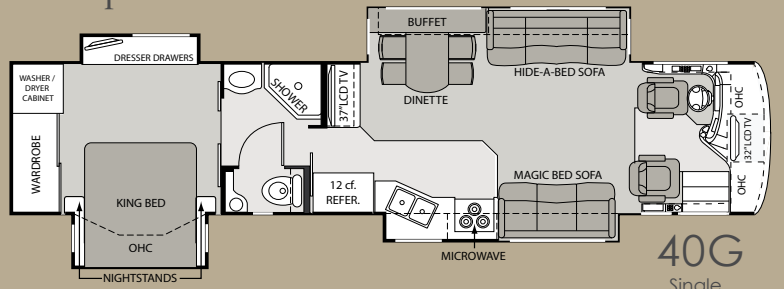

40G
Single
Rear Axle Chassis

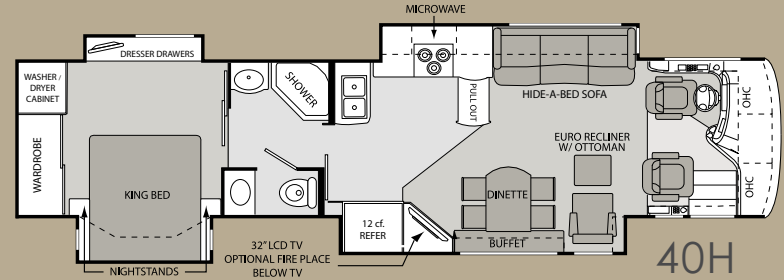

40H
Single
Rear Axle Chassis

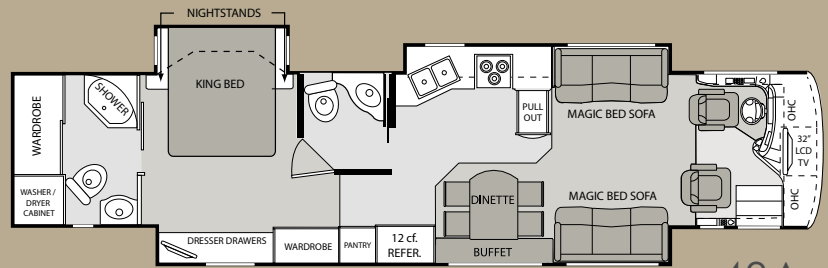

43A
Tag Rear Axle
Chassis

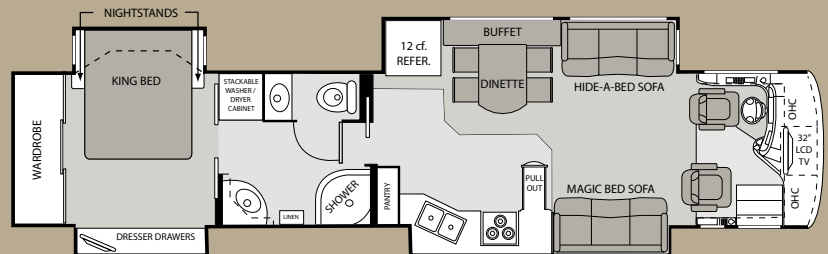

43B
Tag Rear Axle
Chassis

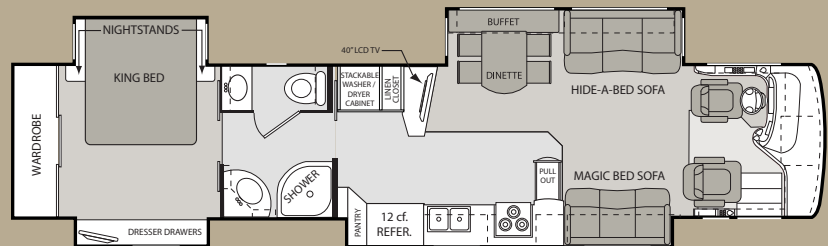

43C
Tag Rear Axle
Chassis



5 LIMITED WARRANTY
STRUCTURAL
YEAR / 60,000 MILE

2008 Mandalay Standard & Optional Features

BODY CONSTRUCTION/ EXTERIOR		COCKPIT				PLUMBING & LP GAS SYSTEMS			
One-piece windshield with steel cage construction	\$	18" Leather-wrapped Smart steering wheel (includes cruise and wiper controls)	\$	Hide-a-bed sofa and two Euro chairs with ottomans (43A only)	O	Jensen® 182 RV radio with weather band and Sirius® satellite radio with six month subscription	\$	High-capacity water pump with full coach filtration system	\$
3" steel framed and laminated floor	\$	Audible turn signals	\$	Two Euro chairs in place of sofa (43B and 43C only)	O	DVD home theater system with recessed ceiling speakers	\$	10-gallon LP gas/electric water heater with DSI	\$
Aluminum framed sidewalls and roof	\$	Adjustable pedals	\$	Two UltraLeather™ Euro recliners with coffee table in place of hide-a-bed sofa (40G only)	O	Digital satellite system	\$	LP gas quick-connect fitting in basement for exterior grill	\$
Molded fiberglass roof cap	\$	Color rear vision camera with one-way audio	\$	Fabric hide-a-bed sofa with air mattress	O	40" LCD television in front overhead (not available on 43C and 40H)	O	Fresh water fill indicator in exterior systems compartment	\$
Chrome exterior mirrors with remote and heat	\$	Color side vision camera system integrated into rear-view mirrors	\$	Fabric magic bed sofa	O	Digital satellite system (in-motion, fully automatic)	O	One-piece fiberglass shower with glass enclosure	\$
Recessed docking lights	\$	UltraLeather™ six-way power driver seat	\$	Fireplace (40G, 40H and 43C only)	O	High-definition television upgrade with two DirecTV® HD receivers	O	Systems compartment with easy access to hook-ups	\$
Hydraulic generator slide-out tray	\$	UltraLeather™ extra-wide passenger seat with power 6-way adjustment and foot-rest	\$	Polished porcelain tile throughout living area	O	GPS navigation system	O	Holding tank rinsing system	\$
Full-body paint package with double clear-coat finish	\$	Electric flush mounted step-well cover	\$	GALLEY		Sidewall mounted exterior entertainment center with 32" television	O	Exterior shower	\$
Automatic compartment lights	\$	Dash fans	\$	12-cubic-foot two-way Stainless Steel refrigerator with ice maker	\$	BEDROOM/BATHROOM		WINDOWS, DOORS & AWNINGS	
Side opening exterior compartment doors	\$	Air horns	\$	3-burner cooktop with drawers	\$	72" x 80" king-size bed with Select Comfort™ air mattress and dual controls	\$	Radius dual pane windows with tinted safety glass	\$
Full pass-through slide-out storage tray	\$	MCD™ power sun visor and manual privacy shade system	\$	30" Stainless Steel over-the-range convection microwave oven	\$	Wardrobe and dresser storage	\$	Weather Pro™ automatic patio awning	\$
Power entry step with light	\$	INTERIOR		Flush mounted two-piece range cover	\$	Bedsread and pillows	\$	Automatic front door awning	\$
Electric power slide locks	\$	Full 84" interior ceiling height	\$	Full-extension drawer guides	\$	Black-out shades in bedroom	\$	Driver side living room slide-out window awning	\$
Aluminum rear roof ladder	\$	Choice of interior decor packages	\$	Mystera® solid surface kitchen countertop with Stainless Steel sink	\$	Washer/dryer prep	\$	Bedroom window awning	\$
Full-length mud flap with Mandalay logo	\$	Polished porcelain tile floor in entry way, kitchen and bathroom	\$	Roll-out countertop extension with drawers (40H, 43A, 43B and 43C only)	\$	Mystera® solid surface lavatory countertop with integrated sink	\$	Keyless entry with baggage door lock remote	\$
3M front film mask	O	Sculpted carpeting with pad in living area and bedroom	\$	Free-standing buffet dinette with two fixed and two folding chairs	\$	Bedroom television wired for satellite connection	\$	HEATING, VENTS & AIR CONDITIONING	
Roof mounted spotlight with remote control	O	Solid wood raised panel cabinet doors	\$	Central vacuum system	\$	Vented combination washer/dryer	O	Dual 15,000 BTU roof air conditioners with heat pumps	\$
Basement refrigerator/freezer on slide tray	O	Cedar lined rear wardrobe closet	\$	Round free-standing table with two fixed and two folding chairs	O	Stackable washer/dryer (43B and 43C only)	O	Triple 15,000 BTU roof air conditioners with heat pumps (43A, 43B and 43C only)	\$
Second pass-through slide-out storage tray (one-way with hydronic heating)	O	Hardwood Golden Maple cabinetry	\$	Gemstone® solid surface kitchen sink	O	SAFETY/CONVENIENCE		30,000 BTU front furnace and 20,000 BTU rear furnace	\$
CHASSIS		Day/night shades in living room	\$	12-cubic foot two-way raised panel refrigerator with ice maker	O	Entry door with deadbolt lock	\$	Dash heating and air conditioning system with defroster	\$
Freightliner XC raised rail chassis—single rear axle (40G and 40H only)	\$	Soft-Touch vinyl ceiling	\$	Dishwasher drawer (not available on 40H)	O	Systems Control Center	\$	Attic fan in kitchen with rain sensor and wall switch control	\$
Freightliner XC raised rail chassis—tandem rear axle (43A, 43B and 43C only)	\$	Fluorescent ceiling lighting	\$	3-burner cooktop with oven (not available on 40H)	O	Smoke, LPG and carbon monoxide detectors	\$	Fantastic® vent with wall switch in bathroom (not available on 43A)	O
425-HP Cummins ISL diesel engine with two-stage engine compression brake	\$	Mood lighting above crown molding on top of all slide rooms	\$	ENTERTAINMENT & ACCESSORIES		Fire extinguisher	\$	ELECTRICAL SYSTEMS	
Independent front suspension with air disc brakes and 60° wheel cut	\$	UltraLeather™ hide-a-bed with air mattress (40G, 40H, 43B and 43C only)	\$	32" LCD television in front overhead (not available on 40H and 43C)	\$	Integral three-point seatbelts for the driver and passenger	\$	Onan® RV Quietdiesel™ 8,000-watt generator	\$
Rear radiator (40G and 40H only)	\$	UltraLeather™ magic bed sofa (40G, 43B and 43C only)	\$	23" LCD television in bedroom	\$	Deluxe acrylic lighted exterior grab handle	\$	Onan® RV QuietDiesel™ 10,000-watt generator (43A, 43B and 43C)	\$
Side radiator (43A, 43B and 43C only)	\$	Dual UltraLeather™ magic bed sofas (43A only)	\$	40" LCD television in living room entertainment center (43C only)	\$	ELECTRICAL SYSTEMS		Automatic generator start	\$
Allison MH 3000 6-speed automatic transmission	\$	UltraLeather™ Euro recliner (40H only)	\$	37" LCD television in living room entertainment center (40G only)	\$	Remote generator start in bedroom	\$	2,000-watt inverter with 100-amp charger and four 6-volt deep cycle house batteries	\$
10,000-lb. hitch receiver and six point connector	\$	Hardwood Cherry or Natural Cherry cabinetry	O	32" LCD television in living room entertainment center (40H only)	\$	Energy management system	\$	50-amp power cord reel	\$
Four-point, fully automatic hydraulic leveling jacks	\$	UltraLeather™ Euro recliner and ottoman with computer table (40E, 40G, 43B and 43C only)	O					Energy management system	\$
Aluminum wheels with 275/80R 22.5" tires	\$								
Air suspension and brakes	\$								
150-gallon fuel tank	\$								

2008 Mandalay Specifications

MODEL	40G	40H	43A	43B	43C
CHASSIS					
Freightliner XC with a 425-HP Cummins ISL engine and 1,200 lb. ft. of torque	X	X	X	X	X
WEIGHT RATING (LBS.)					
Gross Vehicle (GVWR)	34,320	34,320	44,320	44,320	44,320
Gross Combined (GCWR)	44,320	44,320	54,320	54,320	54,320
MEASUREMENTS					
Wheel Base	276"	276"	276"	276"	276"
Exterior Length (without ladder)	41'6"	41'6"	44'6"	44'6"	44'6"
Exterior Height (with air conditioner)	12'9"	12'9"	12'9"	12'9"	12'9"
Interior Height	84"	84"	84"	84"	84"
Awning Size	21'	14'	21'	21'	21'
CAPACITIES					
Fuel (gallons)	150	150	150	150	150
LPG (pounds)	130	130	130	130	130
Fresh Water (gallons)	102	102	120	120	120
Waste Water (gallons)	56	56	56	56	56
Gray Water (gallons)	66	66	66	66	66
Water Heater (gallons)	10	10	10	10	10
Furnace front/rear (BTUs)	30K/20K	30K/20K	30K/20K	30K/20K	30K/20K

VEHICLE LOADING: Every effort has been made to provide the greatest number of options for the recreation vehicle owner. Along with these choices comes the responsibility to manage the loads that are imposed by the choices so that they remain within the manufacturer's specified chassis weight limits. Do not overload the recreation vehicle.

IMPORTANT: Towing capacity may vary by chassis model, floorplan, options and loading of the vehicle. This may result in a towing capacity which is less than the maximum capacity of the hitch. Do not exceed the vehicle's Gross Combined Weight Rating (GCWR), or the hitch rating. A separate functioning brake system is required for any towed vehicle or trailer weighing more than 1,000 lbs. (450 KG) when fully loaded.

WARNING: This information is intended as a guide only. Weights of individual vehicles may vary. Consult your owner's manual and weight sticker affixed to each vehicle for complete loading, weighing, and towing instructions. Actual filled LP capacity is 80% of listing due to safety shut-off required on tank.

WARRANTY: This vehicle is provided with a one-year, 15,000-mile limited warranty and a five-year, 60,000-mile limited structural warranty. Chassis, component part and appliance manufacturers issue limited warranties covering those portions of the vehicle not covered by the limited warranties issued by Mandalay Luxury Division. To learn what portions of the vehicle are excluded from coverage under the limited warranties issued by Mandalay Luxury Division, please contact your selling dealership or Mandalay Luxury Division directly, or review the warranty packet inside the vehicle.

NOTE: Product information, specifications, and photography in this brochure were as accurate as possible at time of printing. Photographs may contain some features that are optional on your vehicle. Since we continually strive to improve our products, actual products may differ. The manufacturer reserves the right, at any time, to make changes in product design, materials, component specifications and pricing, without notice. All capacities are approximate and dimensions are nominal. Some features or options may be different or unavailable in Canada.



Mandalay Owner Benefits

In addition to owning one of the finest Class A diesel motorhomes in the industry, we offer Mandalay owners lots of extras.

With the purchase of a new Mandalay, you will receive two complimentary jackets



and caps from Mandalay Luxury Division. Plus, you are eligible to become a member of Mandalay Travel Club. It is a great way to meet other owners of Mandalay Luxury Division motorhomes, and have the opportunity to participate in unique group tours and attend rallies all over the country. To learn more about the Mandalay Travel Club, visit our website at www.mandalaycoach.com.

www.MANDALAYCOACH.com