

27.1

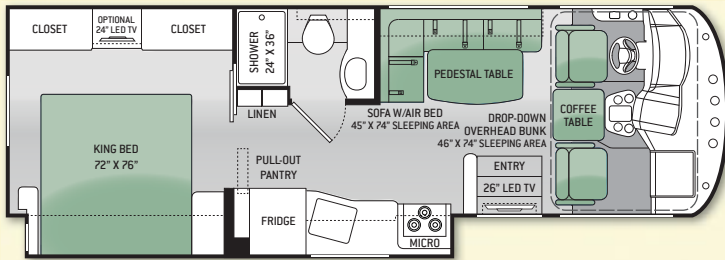

29.2

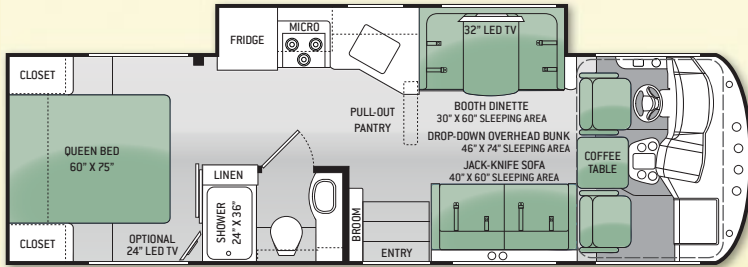

29.3

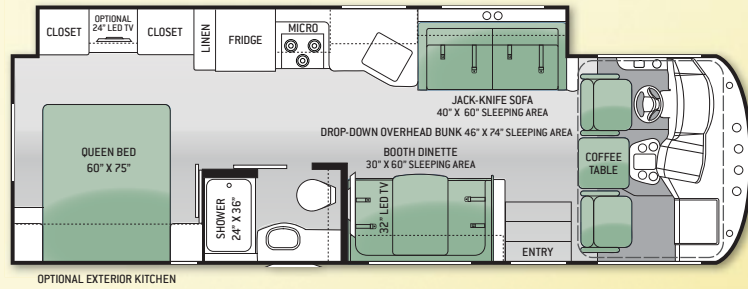

30.1

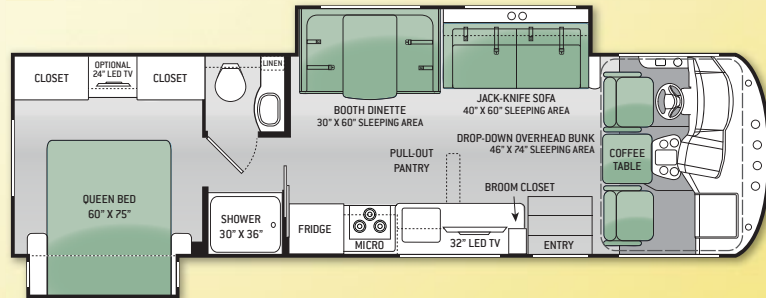

30.2

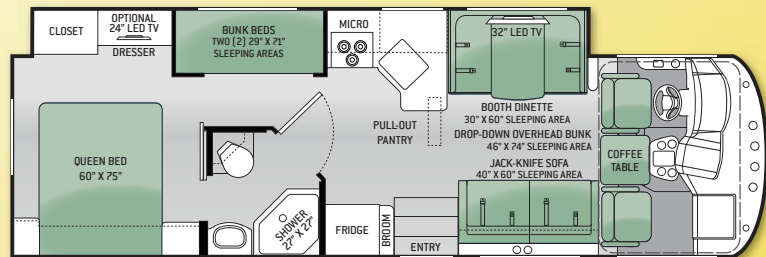

**A.C.E.**



**AUTUMN SLATE FULL BODY PAINT**



**HARMONY HD-MAX™**



**TRAVERTINE FULL BODY PAINT**



**RHYTHM & BLUES HD-MAX™**

FLOOR PLAN	27.1	29.2	29.3	30.1	30.2
Chassis	Ford	Ford	Ford	Ford	Ford
Gross Vehicle Weight Rating (GVWR)	16,000	16,000	18,000	18,000	18,000
Gross Combined Weight Rating (GCWR)	23,000	23,000	23,000	23,000	23,000
Wheel Base	178"	190"	190"	190"	190"
Exterior Length (w/o ladder)	28'-7"	29'-7"	29'-7"	30'-10"	31'-4"
Exterior Height (w/AC)	12'-2"	12'-2"	12'-2"	12'-2"	12'-2"
Exterior Width (w/o mirrors)	99"	99"	99"	99"	99"
Interior Height	84"	84"	84"	84"	84"
Awning Size	14'	14'	18'	14'	19'
Fuel (gal)	80	80	80	80	80
LPG (lbs)	88	88	88	88	88
Fresh/Waste/Gray Water (gal)	50/29/44	50/24.5/44	50/26/47	50/24.5/44	50/28/40
Water Heater (gal)	6	6	6	6	6
Furnace (BTUs)	30,000	35,000	35,000	35,000	35,000
Exterior Storage Capacity (cu. ft.)	80	122.6	84	68	95

**THOR**  
MOTOR COACH  
Made to fit.

**CONSTRUCTION & EXTERIOR**

- Ford F-53 SuperDuty Chassis - 6.8L Triton® V10 Engine, 362HP, 457 lb.-ft. Torque - TorqShift® 5-Speed Automatic with Overdrive Transmission
- One-Piece Fiberglass Front Cap
- Fully Welded Tubular Steel Welded Floor System
- Fully Welded Tubular Aluminum Roof & Sidewall Cage Construction
- Vacu-Bond Laminated Roof, Walls & Floor with High-Density Block Foam Insulation
- Premium One-Piece TPO Roof
- HD-MAX™ Exterior with Graphics Package
- Automatic Hydraulic Leveling Jacks with Touch Pad Controls
- MEGA Storage™ Compartment
- Rotocast Storage Compartments
- Pet-Link™ Multi-Purpose Tie-Down
- Power Patio Awning with Integrated LED Lighting
- Frameless Windows
- Rubber Tread Entry Steps with Utility Storage & Mudroom™ Compartment
- Automatic Single Electric Entry Step
- Outside Shower
- Roof Ladder

**CONSTRUCTION & EXTERIOR OPTION**

- Full Body Paint Package with Gel-Coat Sidewalls

**AUTOMOTIVE & COCKPIT**

- Touchscreen Dash Radio with CD Player & Back-up Monitor
- Heated/Remote Exterior Mirrors with Integrated Side View Cameras
- Reclining/Swivel Leatherette Captain's Chairs

- Stow-Away Coffee Table between Captain's Chairs
- Windshield Privacy Shade
- Conversation Mirrors
- Bird's Eye™ Window
- Valve Stem Extenders on Rear Tires
- 19.5" Tires with Stainless Steel Wheels
- 8,000-lb. Trailer Hitch\*
- Dash Workstation with 110-volt & 12-volt Outlets

**INTERIOR**

- Residential Vinyl Flooring (except in Cockpit)
- 84" Interior Ceiling Height
- Hard Vinyl Ceiling
- LED Ceiling Lighting
- Ceiling Ducted Air Conditioning System
- Flat Panel Cabinetry with Nickel Finish Hardware
- Better Homes and Gardens® RV Fabric Collection
- Leatherette L-Shaped Sofa with Air Bed & Pedestal Table [27.1]
- Leatherette Jack-Knife Sofa [29.2, 29.3, 30.1 & 30.2]
- Leatherette Booth Dinette [29.2, 29.3, 30.1 & 30.2]
- Power Drop Down Hide-Away Overhead Bunk
- Night Shades

**INTERIOR OPTION**

- Powered Fan in Living Area

**KITCHEN**

- Double Door Refrigerator
- 3-Burner Gas Cooktop with Oven
- Microwave Oven
- Laminate Countertops

- Oversized Bowl Sink with Single Lever Gooseneck Faucet
- Pull-Out Pantry
- Coat/Broom Closet with Hanging Hooks [29.2, 30.1 & 30.2]
- Waste & Recycling Containers
- Ball-Bearing Metal Drawer Guides

**BEDROOM & BATHROOM**

- King Size Denver Mattress® Weekender [27.1]
- Queen Size Denver Mattress® Weekender [29.2, 29.3, 30.1 & 30.2]
- Designer Headboard, Bedspread & Pillow Shams
- Bunk Beds [30.2]
- Linen Closets in the Hallway & Bathroom [27.1, 29.2 & 29.3]
- Linen Closet in Bathroom [30.1]
- Pull-Out Kibble Station™ with FDA Approved Pet Bowl Liner
- Foot Flush Porcelain Toilet
- Curved Shower Rod with Micro Anti-Bacterial Shower Curtain [27.1, 29.2, 29.3 & 30.1]
- Shower with Glass Door [30.2]

**BEDROOM & BATHROOM OPTION**

- Powered Fan in Bedroom

**ENTERTAINMENT**

- 26" LED TV in Living Area [27.1]
- 32" LED TV in Living Area [29.2, 29.3, 30.1 & 30.2]
- Two (2) 13" LED TVs & DVD Player in Bunk Bed Area [30.2]\*
- Bluetooth Coach Radio System in Bedroom with Exterior Speakers
- Power Charging Center for Electronics
- Cable TV & Satellite Ready

**ENTERTAINMENT OPTIONS**

- 24" LED TV in Bedroom
- Exterior 32" LED TV
- Exterior Kitchen with 1000-watt Inverter, 2.5 cu. ft. Refrigerator, Sink & Portable Gas Grill [29.3]

**ELECTRICAL & PLUMBING**

- Cummins Onan® RV QG 4000 Gas Generator
- 30-amp Service with Detachable Shoreline Power Cord
- 13,500 BTU Roof Air Conditioner
- Emergency Start Switch
- Battery Disconnect Switch
- Below-Floor Mounted 6-gallon DSI Gas/Electric Water Heater [27.1, 29.2 & 30.1]
- Above-Floor Mounted 6-gallon DSI Gas/Electric Water Heater [29.3 & 30.2]
- Below-Floor Mounted 30,000 BTU LP Furnace [27.1]
- Below-Floor Mounted 35,000 BTU LP Furnace [29.2 & 30.1]
- Above-Floor Mounted 35,000 BTU LP Furnace [29.3 & 30.2]
- Water Heater Bypass System
- Heated & Enclosed Holding Tanks [27.1, 29.2 & 30.1]
- Holding Tanks with Heat Pads [29.3 & 30.2]
- Systems Control Center

**ELECTRICAL & PLUMBING OPTIONS**

- 15,000 BTU Roof Air Conditioner
- Second Auxiliary House Battery

\*INCLUDED ON UNITS BUILT AFTER 10/1/14

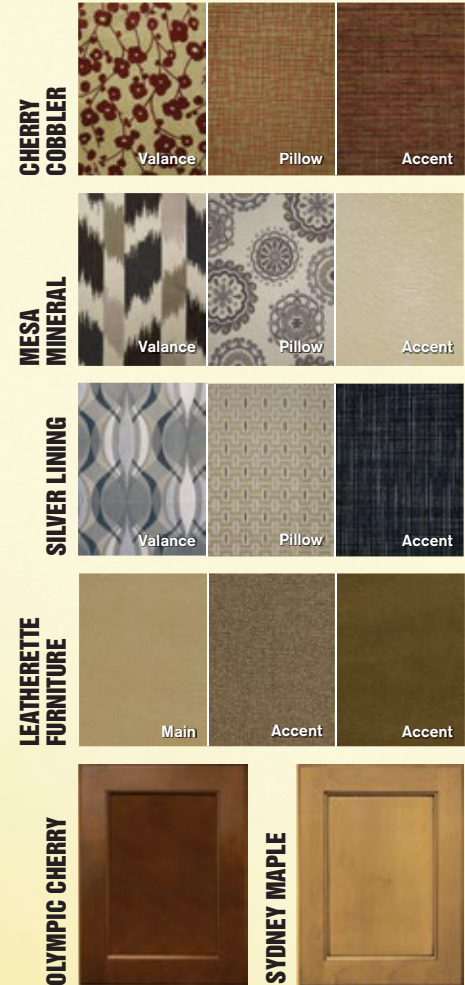

YOUR LOCAL TMC DEALER:



Made to fit.

P.O. Box 1486, Elkhart, Indiana 46515  
Sales Department: 800.860.5658 • Customer Service: 877.855.2867

ACEMOTORHOME.COM



Go RVing.

IMPORTANT - PLEASE READ: This brochure reflects product design, fabrication, material, components and specifications at the date of printing, which date is disclosed on the last page. PLEASE VISIT US ONLINE AT THORMOTORCOACH.COM OR CONSULT WITH YOUR SELLING DEALERSHIP FOR THE LATEST IN STANDARDS, OPTIONS, SPECIFICATION AND TECHNICAL INFORMATION. Photographs in the brochure may depict optional equipment or may only be available in certain floor plans. Components, appliances and the chassis may have been manufactured in a calendar year before the vehicle's designated model year. All capacities are approximate. The actual length of the vehicle may differ from that indicated in the brochure due to variances in the manufacturing processes and/or installed components. All dry weights are based on standard model features and do not include optional features or equipment. Component part and appliance manufacturers issue limited warranties covering portions of the vehicle not covered under the limited warranty we issue.