

RED HAWK

CLASS C MOTORHOMES

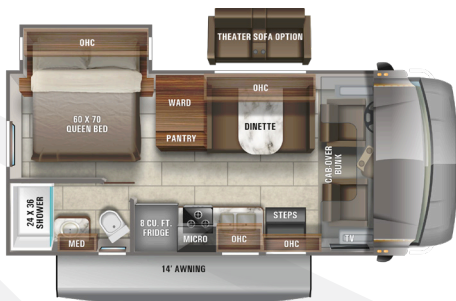

22J Ext. Lgth: 24' 8" Wheelbase: 223" GVWR: 14,500 lbs.

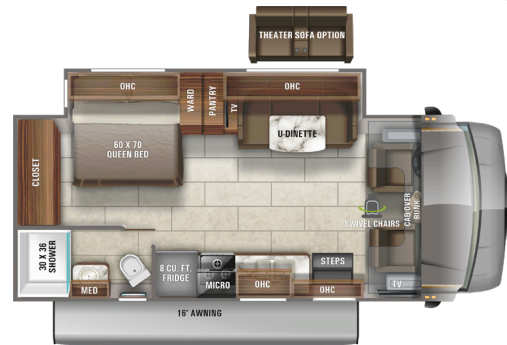

24B Ext. Lgth: 26' 8" Wheelbase: 181" GVWR: 14,500 lbs.

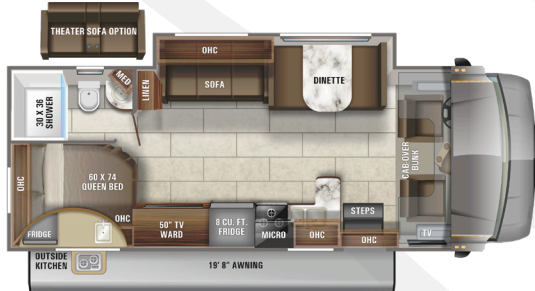

25R Ext. Lgth: 28' 8" Wheelbase: 181" GVWR: 14,500 lbs.



26XD Ext. Lgth: 28' 8" Wheelbase: 181" GVWR: 14,500 lbs.

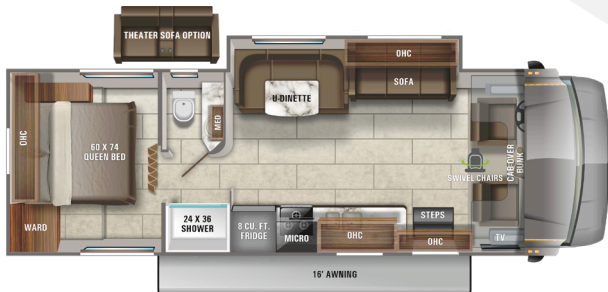

29XK Ext. Lgth: 32' 6" Wheelbase: 223" GVWR: 14,500 lbs.

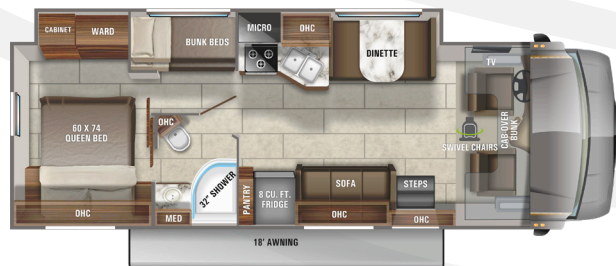

31F Ext. Lgth: 32' 6" Wheelbase: 223" GVWR: 14,500 lbs.

EXTERIOR GRAPHICS PACKAGE



STANDARDS & OPTIONS

CUSTOMER VALUE PACKAGE

JRIDE®: Computer-balanced driveshaft, standard front and rear stabilizer bars, Hellwig® helper springs, rubber isolation body mounts
 One-piece, seamless, fiberglass front cap
 Heated holding tanks (12V pads)
 Electric patio awning with LED lights
 Black holding tank sprayer
 Sony® infotainment center Apple® CarPlay™ and Android Auto™
 Backup camera
 LED HDTV in living area
 8 cu. ft. flush-mount, double-door refrigerator

STANDARD DRIVING EQUIPMENT

Ford® E-450 chassis
 GVWR- 14,500 lb.
 GCWR- 22,000 lb.
 7.3L V-8 350 HP engine with 468 ft.-lb. torque
 6-speed TorqShift® series transmission with overdrive
 210-amp alternator
 E-rated highway tires- LT225/75R16
 Tire pressure monitoring system (TPMS)
 Power anti-lock brakes with power steering
 7,500 lb. hitch with 750 lb. tongue capacity and 7-pin plug
 12V chassis battery
 55 gal. fuel tank
 Remote-controlled, side-view mirrors
 Swivel driver and passenger seats (N/A 22J, 25R)
 Driver and passenger air bags
 Power windows and door locks
 Tilt steering wheel
 A/C and cruise control
 Auxiliary start switch
 Privacy curtains for cab area

STANDARD EXTERIOR EQUIPMENT

StrongholdVBL™ Vacuum-Bond laminated roof, floor and sidewalls
 Bead-foam insulation (R-15 max roof, R-9 max floor, R-5 max walls)
 TPO laminated roof
 Aluminum running boards
 Fiberglass exterior walls with vinyl graphics
 Leveling jack prep
 Frameless windows
 Remote keyless entry
 Entrance door with industry's largest travel view window
 Electric-powered entrance step with integrated house battery compartment
 12V house battery
 (2) high-output, marine-grade exterior speakers
 Slideout cover awnings
 Pass-through storage compartment with light (select models)
 12.2 gal. propane tank (41 lb.)
 LP quick-connect hookup
 Exterior utility center
 Winterization drain system
 Outside shower
 12V demand water pump
 Onan® 4,000-watt MicroQuiet™ generator with auto-changeover
 30-amp electrical service
 Solar prep
 Third brake light
 Porch light
 Roof ladder
 4 in. bumper tube sewer hose storage

STANDARD INTERIOR EQUIPMENT

84 in. ceiling height
 High-intensity, recessed LED ceiling lights
 LED-lit slideout fascia
 Hardwood cabinet doors and drawers
 Ball-bearing drawer guides
 Jayco-exclusive, easy-operation legless dinette table
 2-point lap safety belts in all designated seating locations

Interior entrance door grab handle
 Interior command center
 Pleated blackout shades
 15,000 BTU ducted A/C
 31,000 BTU auto-ignition furnace
 6 gal. gas/electric DSI auto-ignition water heater
 Blu-Ray™ player in living area
 Prep for satellite dish
 Cable TV hookup with RG-6 coax
 Digital antenna with signal booster
 Furriion® all-in-one cooktop and oven
 Convection microwave
 Stainless steel kitchen sink
 Decorative kitchen backsplash
 Pop-up charging station with 110 outlet and USB plugs
 LED-lit, pressed countertops
 Water filtration system
 Shower with decorative ABS surround and skylight
 Removable clothing rod in shower
 Stainless steel bathroom sink
 Toilet with foot flush
 Vent fan in bathroom
 Queen-sized bed with bedspread
 Under-bed storage (select models)
 Large wardrobes
 Overhead bunk with 750 lb. capacity
 Bunks with industry-exclusive 300 lb. capacity each (31F)
 Smoke alarm
 Carbon monoxide detector

OPTIONS

Hydraulic leveling jacks
 Theater seating (25R, 26XD, 29XK)

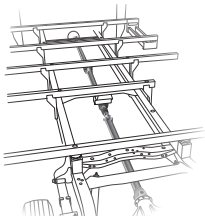

COMPUTER-BALANCED DRIVESHAFT
 Ensures smooth and efficient power transfer to the wheels

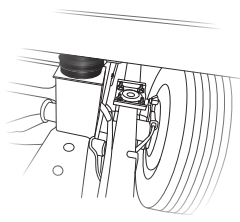

RUBBER ISOLATION MOUNTS Positioned near the tires to absorb road shock, dampen noise and minimize vibrations

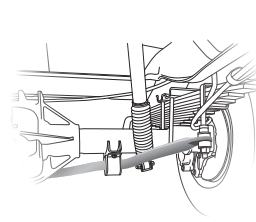

STANDARD FRONT & REAR STABILIZER BARS Reduces the body roll of a vehicle during fast cornering or over road irregularities

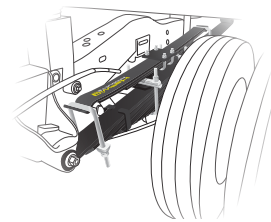

HELLWIG® HELPER SPRINGS Work with the chassis' existing springs to give the RV more support, improving stability under heavy loads



Scan QR code for more information

REDHAWK FLOORPLANS	EXTERIOR LENGTH	EXTERIOR WIDTH	EXTERIOR HEIGHT (WITH A/C)	INTERIOR HEIGHT	WHEEL BASE	FRESH WATER CAPACITY (INCLUDING WATER HEATER)	GRAY WASTE WATER CAPACITY	BLACK WASTE WATER CAPACITY
22J	24' 8"	100"	11' 6"	84"	223"	45	40	31
24B	26' 8"	100"	11' 6"	84"	181"	45	40	31
25R	28' 8"	100"	11' 6"	84"	181"	45	41	32
26XD	28' 8"	100"	11' 6"	84"	181"	45	41	32
29XK	32' 6"	100"	11' 6"	84"	223"	45	41	32
31F	32' 6"	100"	11' 6"	84"	223"	45	41	31

Some specs at the time of print may include estimates, for the most updated information, please visit Jayco.com

It is important for your safety and enjoyment that you are aware of the weights and tow ratings of the RV you select. Consult a competent advisor for questions or advice. Whether you are new to RVing or a veteran, get a feel for the performance of your RV before heading out on the roadways. When you tow a vehicle with your RV, you must drive differently than when you drive a single vehicle. Practice hooking up, driving, backing up and braking in a safe environment or seek out professional instruction. Jayco affixes a weight label to each RV which lists weight information for that vehicle. Refer to that label to verify the vehicle will meet your requirements. See specifications chart above.

Gross Vehicle Weight Rating (GVWR): The maximum permissible weight of the motorhome, including the Unloaded Vehicle Weight (UUV) plus passengers, personal items, all cargo, fluids, options and dealer-installed accessories. The GVWR is equal to or greater than the sum of the UUV and the Cargo Carrying Capacity.



Generations of family fun.



TRAVEL WITH CONFIDENCE • NO ONE OFFERS A BETTER WARRANTY

At Jayco, we build our RVs to handle every adventure, then back them with our industry-leading 2+3 limited warranty. Our 2-year limited warranty has you covered for 2 camping seasons. That's 730 days. In addition, our 3-year structural limited warranty has you covered for 3 camping seasons or 1,095 days. You won't find a better limited warranty in the business, because the only strings that we attach are those that deliver the ultimate in reliability. That's the Jayco difference. So go explore. For a copy of our 2-year limited + 3-year limited structural warranty with complete terms and conditions, please contact your local Jayco dealer.

