

# Berkshire<sub>XL</sub>

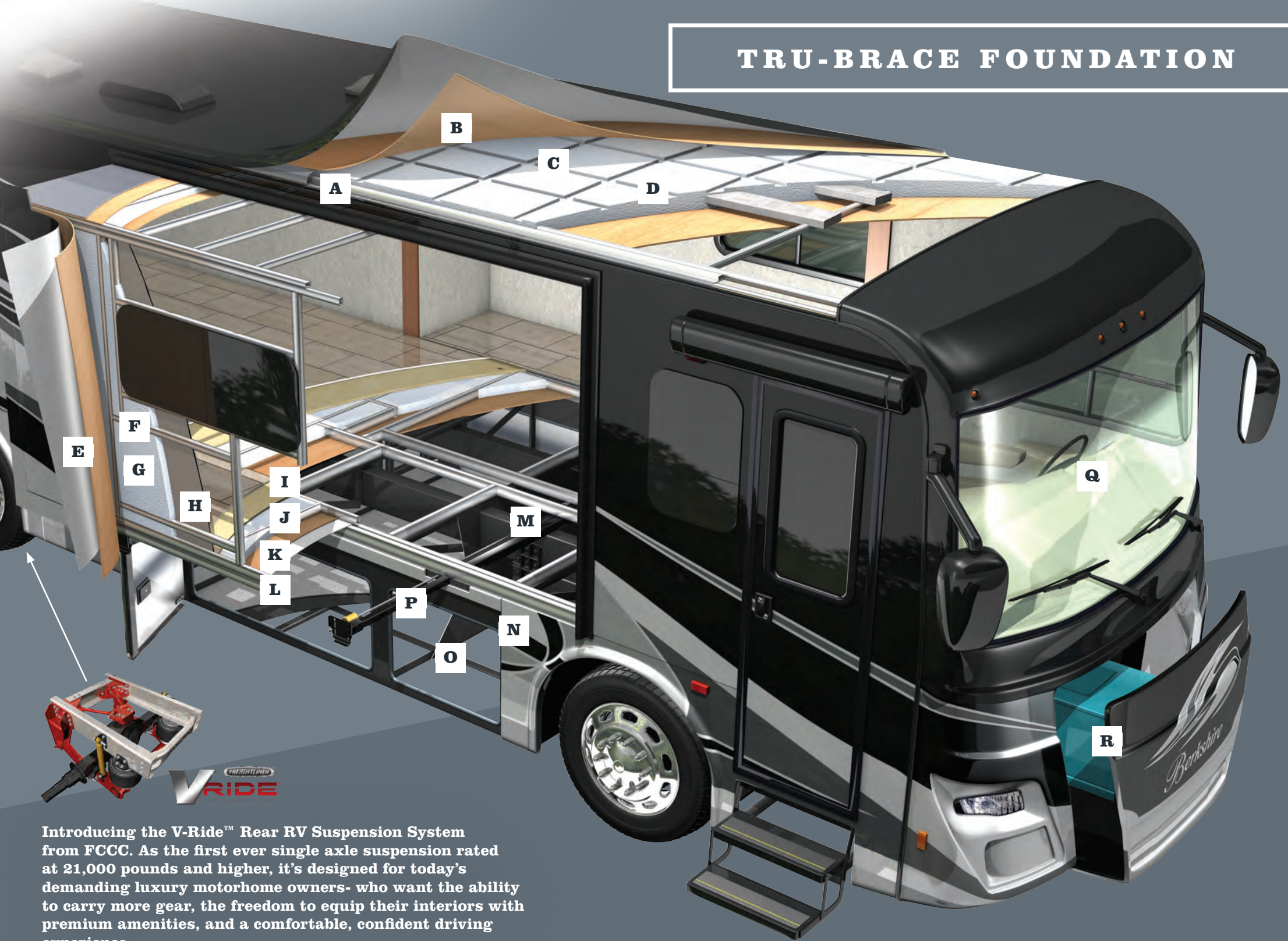

# TRU-BRACE FOUNDATION



Introducing the V-Ride™ Rear RV Suspension System from FCCC. As the first ever single axle suspension rated at 21,000 pounds and higher, it's designed for today's demanding luxury motorhome owners- who want the ability to carry more gear, the freedom to equip their interiors with premium amenities, and a comfortable, confident driving experience.



**1** 6" ROOF AT THE CROWN, WELDED ALUMINUM TUBE - LAMINATED VACUUM BONDED WITH INTEGRATED A/C DUCTING.

**A** FRAMING IS WELDED 2" ALUMINUM TUBE

**B** LAYERED STRUCTURAL 1 PIECE FIBERGLASS

**C** 5-1/4" RADIUS POLYSTYRENE INSULATION

**D** GALVANIZED METAL BACKERS FOR A/C'S, SATELLITE, SOLAR PANEL AND ANTENNAE

**2** 1-7/8" THICK SIDEWALL, WELDED ALUMINUM TUBE - LAMINATED VACUUM BONDED.

**E** LAYERED STRUCTURAL FIBERGLASS SIDEWALL

**F** HEAVY WALL ALUMINUM TUBE AROUND PERIMETER AND AROUND SLIDE OPENINGS

**G** 1-1/2" POLYSTYRENE INSULATION

**H** 1/8" INTERIOR DÉCOR FINISHING BOARD

**3** 3-1/8" FLOOR, VACUUM BONDED LAMINATED

**I** FRAMING IS WELDED 2-1/2" ALUMINUM TUBE.

**J** 2-1/2" POLYSTYRENE INSULATION

**K** 1 PIECE 1/2" STRUCTURE BOARD

**L** DARCO, A WATERPROOF UNDERBELLY MATERIAL

**4** FULL PAINT WELDED STEEL CHASSIS STRUCTURE

**M** TRU-BRACE, CHASSIS STIFFENER SYSTEM

**N** 1 PIECE ALUMINIZED STEEL SIDE SKIRT

**O** 1 PIECE BENT STEEL STORAGE COMPARTMENTS

**P** 1-1/2" INSULATED STEEL TUBE FIREWALL

**5** FIBERGLASS MOLDED FRONT AND REAR CAPS

**Q** 1 PIECE AUTOMOTIVE GRADE BONDED WINDSHIELD

**R** GENERATOR SLIDE SYSTEM

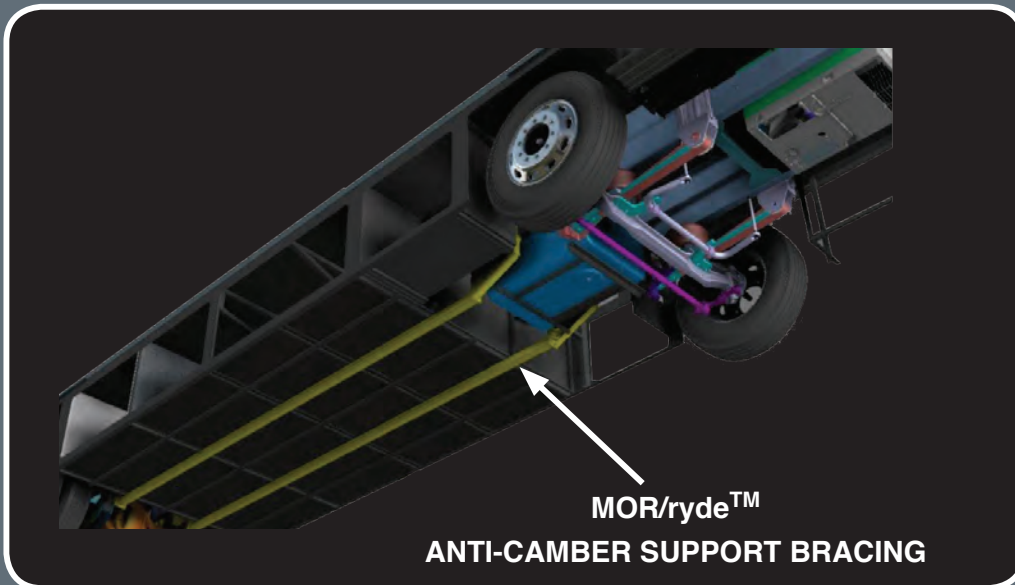

FOR MORE INFORMATION PLEASE VISIT  
[WWW.FORESTRIVERINC.COM/BERKSHIREXL](http://WWW.FORESTRIVERINC.COM/BERKSHIREXL)

*Berkshire*<sub>XL</sub>

# Berkshire<sub>XL</sub>

## 10 FEATURES

1 **FREIGHTLINER XCR RAISED RAIL CHASSIS, CUMMINS L9 TURBO DIESEL, 380 HP @2000RPM, 2200GV RPM 1150 LB/FT @1400 RPM**

2 **ALLISON 3000MH 6-SPEED TRANSMISSION**

3 **ONE (1) PIECE FIBERGLASS ROOF**

4 **FULL HEIGHT, STRUT ASSISTED, INSULATED DIESEL MOTORHOME BAGGAGE DOORS**

5 **TRUMA© TANKLESS HOT WATER HEATER**

6 **INDIVIDUAL WATER MANIFOLD SYSTEM WITH POINT TO POINT PLUMBING**

7 **RUST RESISTANT ALUMINIZED CHASSIS SKIRTS**

8 **PRECISION CIRCUITS MULTIPLEX WIRING WITH SMART PHONE APP CONTROLS**

9 **FULL WALL HYDRAULIC SLIDES**

10 **FULL BODY PAINT FEATURING 4X SIKKENS© CLEAR COAT**



STANDARD EXTERIOR ENTERTAINMENT CENTER



STANDARD 8KW ONAN DIESEL GENERATOR W/MANUAL SLIDE TRAY (OPT 10K)



INDIVIDUAL WATER MANIFOLD SYSTEM WITH POINT TO POINT PLUMBING



STANDARD SLIDE TRAY IN STEEL BASEMENT FULL PASS THRU STORAGE COMPARTMENT

# FLOORPLANS

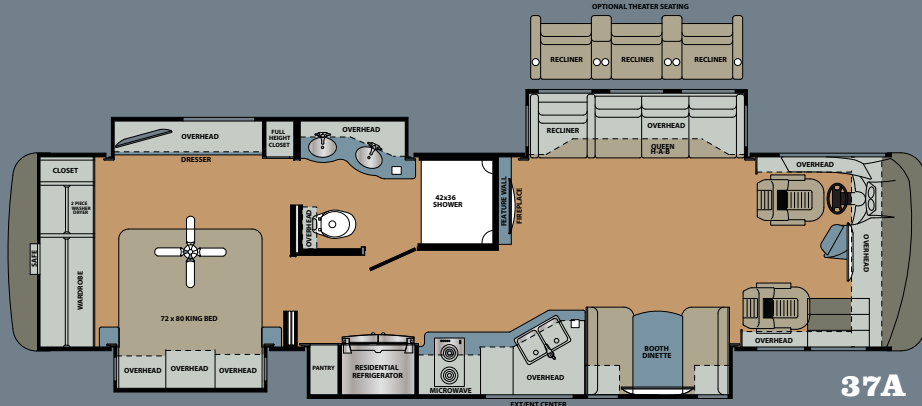

37A

8 = SEAT BELTS

STD. 5 OPT. 7 = SLEEPS

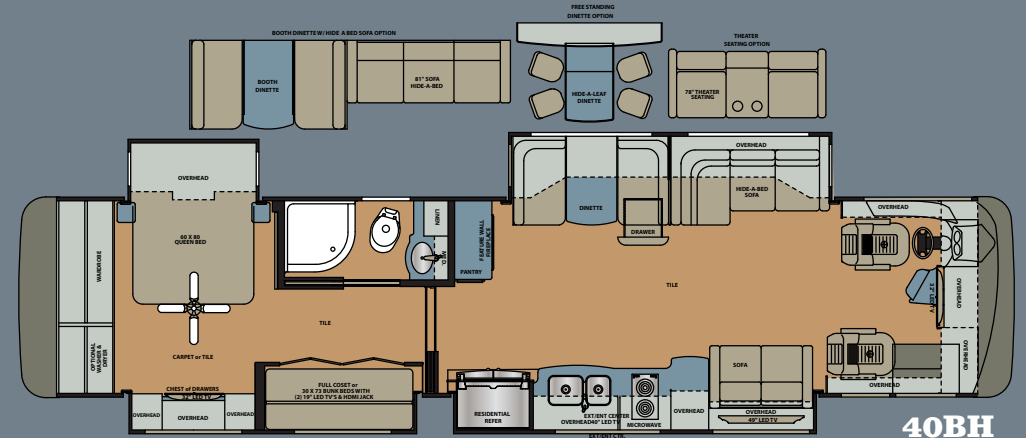

40BH

9 = SEAT BELTS

STD. 8 OPT. 10 = SLEEPS

SEAT BELTS

SLEEPS (STD./STANDARD OPT./WITH OPTIONAL BED LIFT)

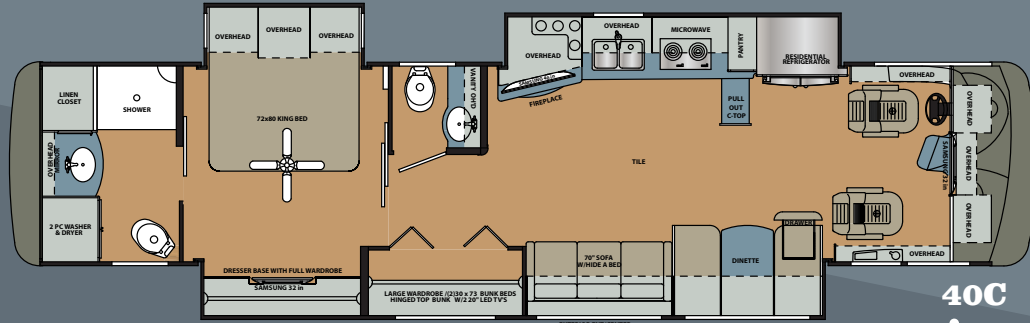

40C

7 = SEAT BELTS

STD. 7 OPT. 9 = SLEEPS

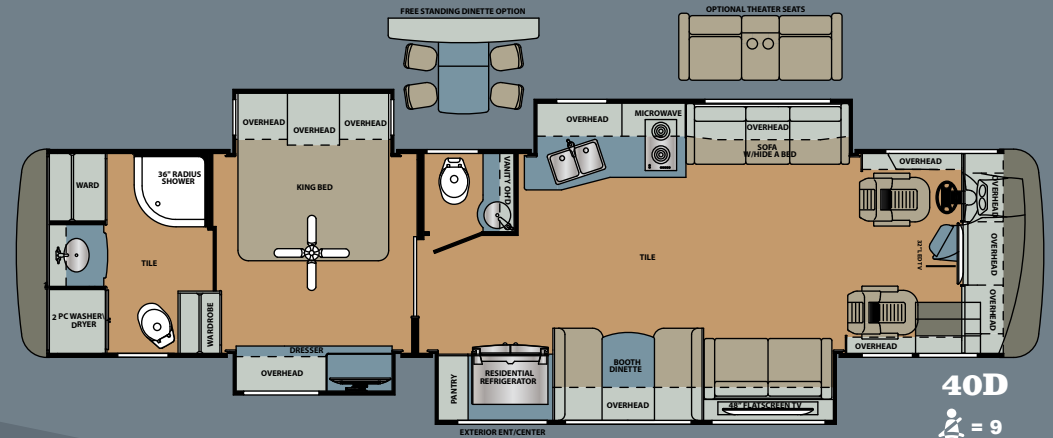

40D

9 = SEAT BELTS

STD. 6 OPT. 8 = SLEEPS

Floorplan	Length (Feet)	GVWR (Lbs.)	GCWR (Lbs.)	GAWR Front (Lbs.)	GAWR Rear (Lbs.)	Wheel-base (Inches)	Height* (Feet)	Width* (Inches)	Basement storage* (Cu. Ft.)	Awning (Feet)	Fresh Tank* (Gal.)	Gray Tank (Gal.)	Black Tank (Gal.)	LP Tank (Gal.)	Furnace (BTU's)	Hot Water
37A	38' 8"	38,320	48,320	14,320	24,000	238"	12' 5"	100"	186'	17' 3"	103	66	42	24.5	40,000	CONTINUOUS
40BH	41' 0"	36,400	46,400	12,400	24,000	266"	12' 5"	100"	220'	10' 5"	103	66	42	24.5	40,000	CONTINUOUS
40C	41' 0"	36,400	46,400	12,400	24,000	266"	12' 5"	100"	220'	18' 0"	103	66	42	24.5	40,000	CONTINUOUS
40D	41' 0"	36,400	46,400	12,400	24,000	266"	12' 5"	100"	220'	13' 6"	103	66	42	24.5	40,000	CONTINUOUS

\*Fresh water tank includes quick drain valve | Please see back cover for more information regarding weights.



# Berkshire<sub>XL</sub>



ALL PICTURES MODEL 40C FEATURING BRONZE MAPLE WOOD GRAIN AND RUSTIC IRON





# STANDARDS + OPTIONS

## CHASSIS

- Freightliner XCR Raised Rail Chassis
- Cummins ISL Turbo Diesel, 380 HP@2000RPM, 2200 GOV RPM 1150 LB/FT @1400 RPM
- Allison 3000MH 6-Speed Transmission
- 120V Engine Heater 1000w
- 22.5" Polished Aluminum Wheels
- Michelin X Line Energy Z 275/80R22.5 Tires
- Trailer Hitch, 10,000 Lb. Capacity
- Allison Electronic Push Button Shifter
- 100 Gallon, Locking Dual Fill Fuel Tank
- Driver Side Fill, 13 Gallon DEF Tank
- Day Time Running Lights
- 7-Pin Tow Power Connector
- 18.7 CFM Air Compressor
- Farr Eco-Air Cleaner
- Power Steering
- Washer/Heavy Duty-Wiper w/Intermittent Function
- Two 1900 CCA Maint. Free Chassis Batteries
- Full Air ABS Brakes w/ Auto Slack Adjuster
- Variable Exhaust Brake
- Telescopic/Tilt Steering Wheel
- Suspension Neway Front And V- Ride Rear
- Sachs Custom Tuned Shock Absorbers
- 55 Degree Wheel Cut
- Auto Air Suspension Deflation System
- Cross Flow, Rear Mounted Radiator
- 5 Year / 100,000 Mile Coolant (Some Maintenance Required)
- V.I.P. Smart Wheel, 4-Spoke 18" Premium Burlwood Steering Wheel
- Electronic Cruise Control with High Idle

## CONSTRUCTION AND EXTERIOR

- Fiberglass Front And Rear Caps
- Full Body Painted Exterior (4X Clear Coat)
- Four (4) Point Fully Auto Hydraulic Leveling System w/Auto Air Dump
- Steel Basement Structure

- TRU-BRACE Chassis Support System
- Rust Resistant Aluminized Steel Chassis Skirts
- Diamond Shield Front Mask Protective Film
- One Piece Fiberglass Roof
- Top-Mount Remote Exterior/Heated/Mirrors/with Cameras
- Frameless Dual Pane, Dark Tint Windows
- Automotive Foam And Ziebart Seal Undercoating
- Carefree Power Door Awning
- Carefree Latitude Patio Awning w/LED Lighting and Wind Sensor
- Carefree Slideout Topper with Covers
- Full Height Strut Assisted Compartment Doors w/Full Pass Through Storage
- "One Key" System, Exterior Compartment, Entry Door & Fuel Fill Doors
- Quiet Integrated A/C Intake/Ducting Roof System
- Crowned and Layered Vacuum Bonded Fiberglass Roof
- Vacuum Bonded 3" Floor w/Tubular Aluminum Frame
- Gel Coat Vacuum Bonded Sidewalls, Slideout Floors & Walls
- Block Foam Polystyrene Insulation in Walls Roof And Floors
- 30" Entryway
- Channeled Drains for A/Cs
- Tubular Steel Firewall w/Polystyrene Insulation
- 84" Interior Ceiling Height
- PTL Steel Entrance Door with Deadbolt
- Auxiliary Air Chuck (Front Driver Side Compartment)
- Auxiliary LP Supply, Quick Connect (Passenger Side)
- LED Marker Lights
- Full Length Mud Flap w/Chrome Forest River Name
- Slide Tray in Basement Compartment

## ELECTRICAL

- 50A Service w/Auto Transfer Switch and 30' Power Cord
- 8Kw Onan Diesel Generator w/Manual Slide Tray
- Energy Management System
- Electronic House Power Disconnect Switch
- Generator Start/Stop Switch (On Dash/Bedroom)
- Multi-Plex with Precision Plex App Control
- Dimmer Control Lighting Throughout
- Individual Reading Lights Bed Overhead
- 2000w Pure Sine Inverter/Converter
- Auto Generator Start Control
- Four (4) Six Volt Deep Cycle House Batteries
- Easy Read 12V Circuit House Load Center
- Solar Panel Controller with Roof Prep
- Ceiling Fan in Bedroom
- Kitchen Accent Lighting

## PLUMBING

- Variable Speed 4 GPM Water Pump
- Individual Zoned Hot/Cold Manifold Water Supply System
- 4-Way Water Management Valve in Water Bay Compartment
- Bath - Solid Surface Under Mount Sink
- Kitchen - Stainless Steel Under Mount Sink
- One Piece Fiberglass Shower w/ Glass Door and Skylight
- Whole House Water Filter
- Porcelain China Bowl Toilet w/Foot Flush (N/A 37A)
- Tecma Macerator Toilet (N/A 40BH)
- Convenience Monitor Panel at Water Bay
- 360 Roof Vent Caps



### **DRIVER/PASSENGER/COCKPIT**

- One Piece Windshield
- Power Front Day/Night Shades
- Passenger & Driver Window Day/Night Shades
- 10" Dash Radio w/ Color Back-Up ,Side View Cameras And Navigation
- Sirius/XM Satellite Roof Mounted Antenna
- Flexsteel Soft Touch Wide Driver Seat Swivel,Recline and 6-Way Power Adjust
- Flexsteel Soft Touch Wide Pass/Seat Swivel, Recline and Power Foot Rest
- Two (2) Defroster Fans with High And Low Settings
- Multiple USB Charging Ports
- Automotive Dash AC/Heater w/Deluxe Controls
- Multiple Auxiliary Charging Ports at Dash
- Power Flush Floor Step-Well Cover
- Driver & Passenger LED Ceiling Map Lights
- Emergency/Aux Engine Start Switch at Dash

### **ENTERTAINMENT**

- 49" LED TV, Living Room (40D Only)
- 40" LED TV, Living Room (N/A 40D)
- 32" LED TV, Bedroom
- 32" LED TV, Front Dash Overhead
- 22" LED TV, (2) Each Bunk with Easy Access HDMI Jack (N/A 37A, 40D)
- JBL Soundbar w/Integrated Sub and Bluetooth
- Roof Mount Winegard Trav'ler Satellite Prep Park/Cable Prep
- High Definition Cat6 Matrix Signal Distribution
- Hi-Definition Digital TV Antenna
- Blu-Ray DVD Player
- Exterior Entertainment Center in Sidewall with 40" TV & Radio with Bluetooth

### **INTERIOR**

- Polished Porcelain Tile Throughout
- Semi Gloss Hardwood w/Glazing- Cabinetry, Interior Doors and Slideout Fascia (Glazing N/A with Executive Dark Cherry Option)
- Living Room Ceiling Crown Trim
- Villa Soft Touch FAB Booth/Sofa Ensemble with Hide-A-Bed & Storage (40BH Only)
- Villa Dream Booth Soft Touch Fab Dinette with Hide-A-Bed Sofa (40C Only)
- Soft Touch Booth & Villa Hide-A-Bed Sofa with Recliner (37A Only)
- Villa Soft Touch Sofa with Hide-A-Bed (40D Only)
- Villa Soft Touch Fab Love Seat (N/A 37A, 40C)
- Polished Solid Surface Kitchen/Bathroom Countertops And Backsplash with Tile Inserts
- Full Extension Ball Bearing Metal Drawer Guides
- Galley Storage Compartment for Sink Covers
- Kitchen Pantry (N/A 40BH)
- Bi-Fold Doors, Bunk Beds (N/A 37A, 40C, 40D)
- "Soft Touch" Padded Ceiling
- Roller Style Day/Night Shades
- 72"X 80" Serta King Bed with Bedspread and Decorative Pillows (N/A 40BH)
- 60"X 80" Serta Queen Bed with Bedspread and Decorative Pillows (N/A 37A, 40C, 40D)
- Bed Night Stands , 1 with Dual USB Jack and Overhead Cabinetry
- Mirrored Vanity Overhead Cabinet Doors
- Towel Bar, Toilet Paper Holder and Towel Ring
- Fitted Cockpit Floormat with "Berkshire" Logo
- LP Gas, Carbon Monoxide and Smoke Detectors
- Fire Extinguisher

### **APPLIANCES**

- 15,000 BTU with Heat Pump (Front & Rear)
- Holding Tank Heat Pads
- Truma Continuous Flow Hot Water
- (2) Dual Zoned 20,000 BTU Furnaces
- 30" OTR Convection Microwave Oven
- 23 Cu. Ft. French Door Residential Refrigerator with Ice Maker
- Electric Induction Glass Cooktop
- Power Fan in Bathroom with Rain Cover
- Maxxair In Galley with Wireless Remote Control and Rain Cover
- Washer/Dryer Prep
- Electric Fireplace
- Central Vacuum System

### **OPTIONS**

- Electric Easy-Bed Lift, Cockpit Area
- Free Standing Dinette w/4 Chairs (40D Only)
- Free Standing Dinette w/4 Chairs and "Hide-A-Bed" Sofa IPO Ensemble (40BH Only)
- Booth Dinette with "Hide-A-Bed" Sofa IPO Ensemble (40BH Only)
- Free Standing Dinette w/4 Chairs and "Theater Seating" IPO Ensemble (40BH Only)
- Booth Dinette With "Theater Seating" IPO Ensemble (40BH Only)
- Theater Seating (N/A 40BH)
- Electronic Safe
- Ceramic Wood Plank Tile Throughout
- Trav'ler (Winegard) Satellite Antenna- Direct TV (Us)
- Trav'ler (Winegard) Satellite Antenna-Shaw (Canada)
- Stackable Washer/Dryer
- Stainless Steel Dishwasher
- 10,000Kw Generator With 3rd 13,500 BTU A/C (N/A 37A)

# PAINT PACKAGES

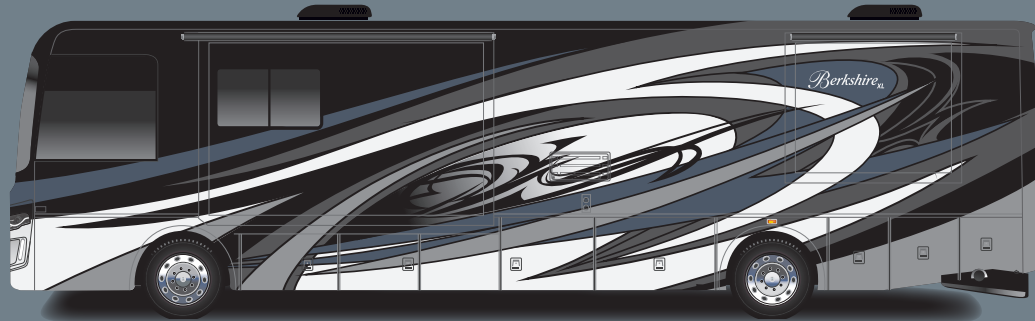

**GLACIAL**

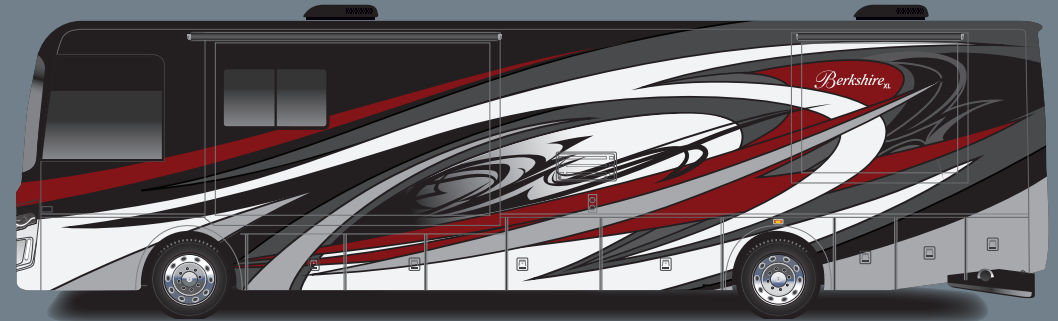

**RUBICON**

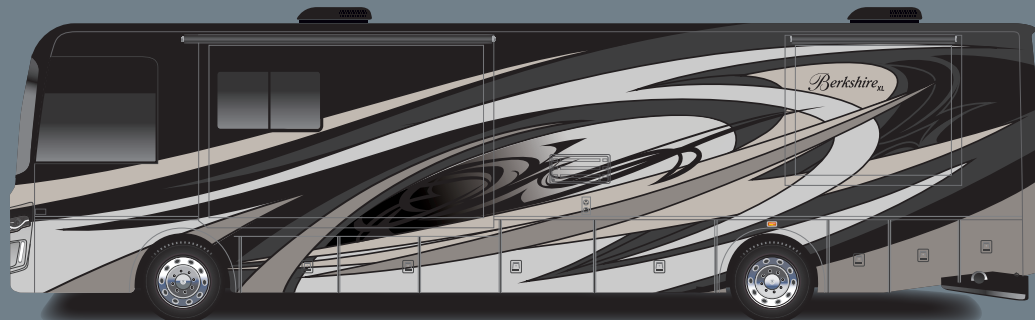

**SUEDE**

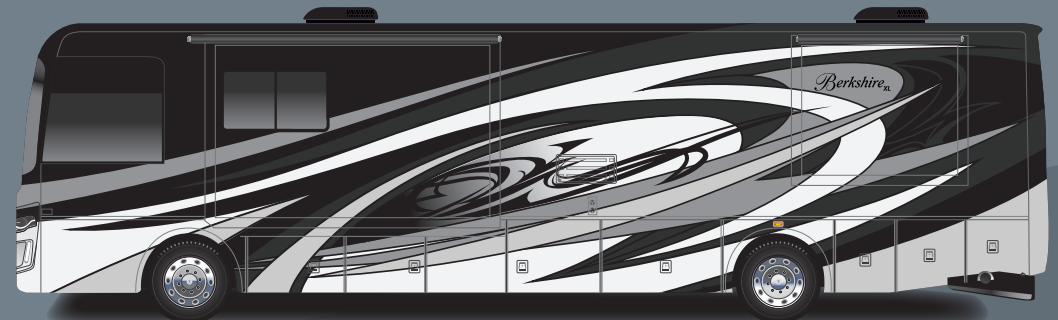

**UMBRA**

*Berkshire* XL

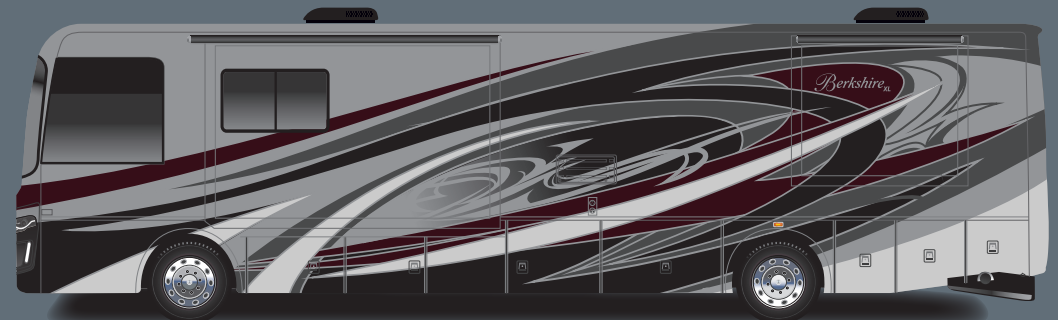

**VELVET**

# CUSTOMIZE YOUR INTERIOR

## WOOD GRAIN OPTIONS (CHOOSE ONE)



NATIVE CHERRY



BRONZE MAPLE

## LEATHERETTE OPTIONS (CHOOSE ONE)

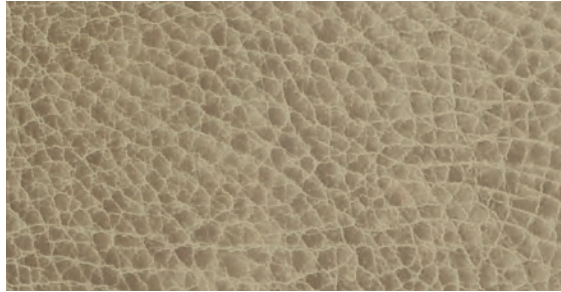

SPARROW

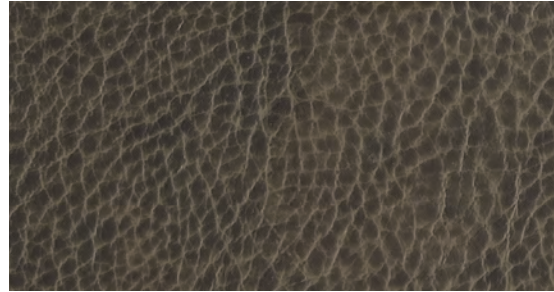

CHESTNUT

## DESIGNER FABRIC OPTIONS (CHOOSE ONE)

### RUSTIC IRON



### SILVER BAY



### STANDARD FLOORING

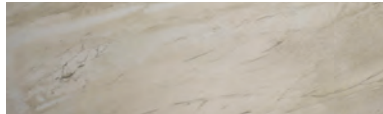

### STANDARD COUNTERTOP



### WOOD PLANK FLOORING OPTION

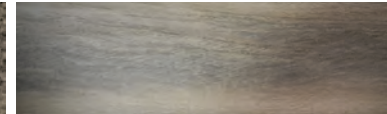

# DECOR OPTIONS

## WHITE DIAMOND PEBBLE FIXED INTERIOR DECOR



EXECUTIVE DARK CHERRY  
WOOD GRAIN

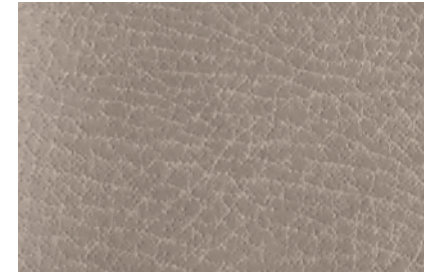

BRISA  
LEATHERETTE

## DESIGNER FABRICS



## WHITE DIAMOND PEBBLE FLOORING



## WHITE DIAMOND PEBBLE COUNTERTOP



## WHITE DIAMOND PEBBLE WOOD PLANK FLOORING OPTION

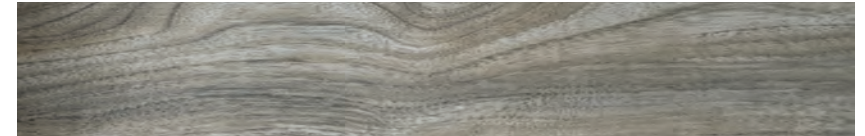

CUSTOMER SATISFACTION



www.ForestRiverBuyLocal.com



**PRE-DELIVERY INSPECTION FACILITY**  
20,000 square feet of quality assurance. The bare essentials for a premium product. This state-of-the-art facility gives immediate daily feedback to production for quality assurance in every unit built.



**GVWR (Gross Vehicle Weight Rating)** - is the maximum permissible weight of the unit when fully loaded. It includes all weights, inclusive of all fluids, occupants, cargo, optional equipment and accessories. For safety and product performance do NOT exceed the GVWR.

**GCWR (Gross Combined Weight Rating)** - Is the maximum permissible loaded weight of your motor home and any towed trailer or towed vehicle. Actual GCWR of this vehicle may be limited by the sum of the GVWR and the installed hitch receiver maximum capacity rating; see hitch rating label for detail.

**GAWR (Gross Axle Weight Rating)** - is the maximum permissible weight, including cargo, fluids, optional equipment and accessories that can be safely supported by each axle.

**UVW (Unloaded Vehicle Weight)\*** - is the typical weight of the unit as manufactured at the factory. It includes all weight at the unit's axle(s), including full fuel, all fluids and LP Gas. The UVW does not include cargo, fresh potable water, additional optional equipment or dealer installed accessories.

\*Estimated Average based on standard build optional equipment.

**CCC (Cargo Carrying Capacity)\*\*** - is the amount of weight available for fresh potable water, cargo, passengers, additional optional equipment and accessories. CCC is equal to GVWR minus UVW. Available CCC should accommodate fresh potable water (8.3 lbs per gallon). Before filling the fresh water tank, empty the black and gray tanks to provide for more cargo capacity.

\*\* Estimated average based on standard build optional equipment.

Each Forest River RV is weighed at the manufacturing facility prior to shipping. A label identifying the unloaded vehicle weight of the actual unit and the cargo carrying capacity is applied to every Forest River RV prior to leaving our facilities.

The load capacity of your unit is designated by weight, not by volume, so you cannot necessarily use all available space when loading your unit.

Actual towing capacity is dependent upon your particular loading and towing circumstances, which includes the GVWR, GAWR and GCWR as well as adequate trailer brakes. Please refer to the Operator's Manual of your vehicle for further towing information.

# Berkshire<sub>NL</sub>



**Learn More**  
Scan this barcode using a QR Reader on your smart phone to learn more about Forest River.



A Berkshire Hathaway company.

Forest River Diesel Division  
1800 W. Hively Ave.  
Elkhart, IN 46517  
(574) 522-3693  
www.forestriverinc.com  
www.forestriveraccessories.com

All information contained in this brochure is believed to be accurate at the time of publication. However, during the model year, it may be necessary to make revisions and Forest River, Inc., reserves the right to make all such changes without notice, including prices, colors, materials, equipment and specifications as well as the addition of new models and the discontinuance of models shown in this brochure. Therefore, please consult with your Forest River dealer and confirm the existence of any materials, design or specifications that are material to your purchase decision.

**FREE MEMBERSHIP**  
to Forest River Owners' Group

www.forestriverfrog.com

©Berkshire - a division of Forest River, Inc.  
A Berkshire Hathaway company

